

BLACK KATZ

Management & Lettings

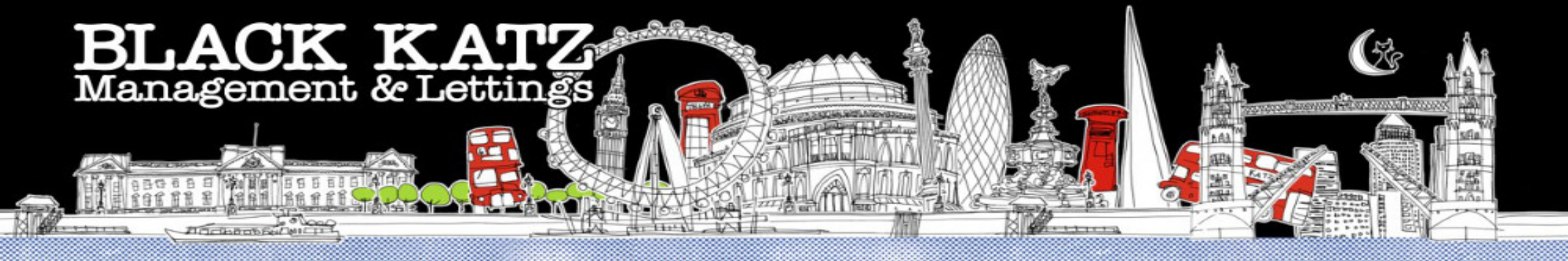

1 Bedroom Flat To Rent In Regents Park / Marylebone £595pw (£2578 pcm)

1 Bedroom Flat To Rent In Regents Park / Marylebone £ 595pw (£2578 pcm)

Recently refurbished this one double bedroom flat is located in the heart of Marylebone. Set on the 1st floor the property the property benefits from an open plan modern kitchen lounge, wooden floors, double bedroom and a tiled bathroom with shower.

Located within minutes of Marylebone and within easy reach of the shops, bars and restaurants of Baker Street, Boston Place is close to a superb range of shops and amenities and is also near to the green open spaces of Regent's Park.

E.P.C. RATING: D

Property Features

. Roof Terrace . Wood Floors . Washing Machine . Fitted Kitchen . Close to local amenities . Close to Tube . Fantastic Transport Links . Zone 1 . Central Heating . Recently Decorated



1 Bedroom Flat To Rent In Regents Park / Marylebone £ 595pw (£2578 pcm)

Boston Place, NW1

Approximate Gross Internal Area
378 sq ft / 35.11 sq m

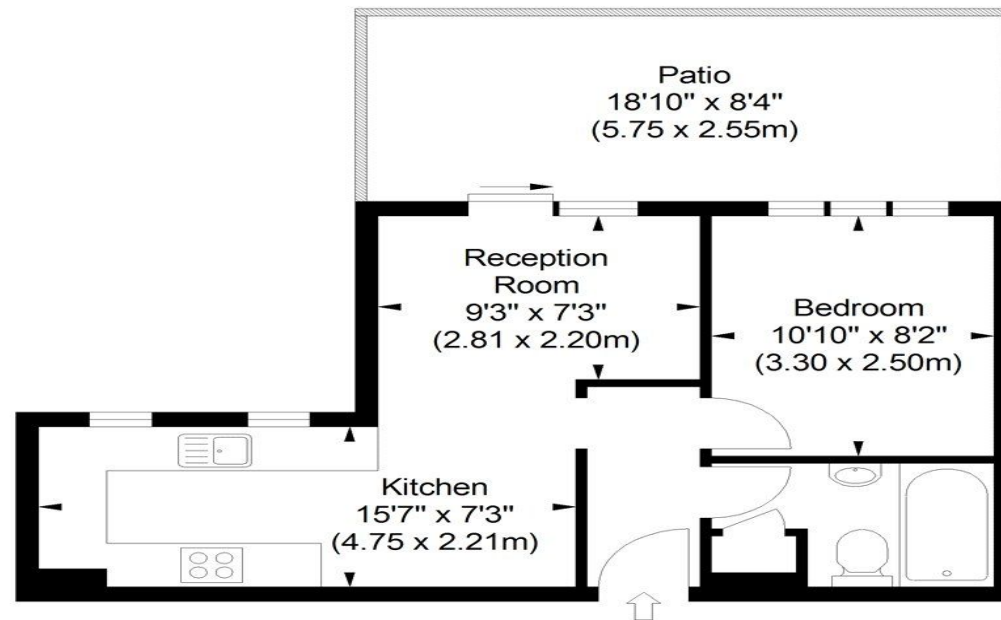

First Floor

ILLUSTRATION FOR IDENTIFICATION PURPOSES ONLY

ALL MEASUREMENTS ARE MAXIMUM, AND INCLUDE WINDOW BAYS AND WARDROBES WHERE APPLICABLE
THIS PLAN MUST NOT BE REPRODUCED BY ANY OTHER PERSON WITHOUT PERMISSION

1 Bedroom Flat To Rent In Regents Park / Marylebone £ 595pw (£2578 pcm)



**69 Parkway
Camden Town
London
NW1 7PP**

**Manager: Dani Anwar
Email: dani@blackkatz.com
Tel: 020 7284 3111**

**Admin: Lauren Dean
Email: lauren@blackkatz.com**

**Office Hours:
Mon-Fri 9.00am-7.00pm
Sat-10am-2.00pm
(Please call beforehand)**

We aim to make our particulars both accurate and reliable. However they are not guaranteed, nor do they form part of an offer or contract. If you require clarification on any points then please contact us. Please note that appliances and heating systems have not been tested and therefore no warranties can be given as to their good working order.