

BLACK KATZ

Management & Lettings



2 Bedroom Apartment To Rent In Borough / Southwark £669 p.w. (£2900 pcm)

2 Bedroom Apartment To Rent In Borough / Southwark£ 669 p.w. (£2900 pcm)

<p>--Available 4th September--</p><p>A fantastic two double bedroomed apartment located on the first floor of this stunning development boasting size, quality and location.This amazing apartment benefits from open-plan integrated kitchen reception room designed to the highest standards, two well-proportioned bedrooms, two modern bathrooms and charming private balcony.The development also benefits from concierge service. The highly desirable development is positioned within short walk from Borough and Southwark tube stations and only stone throw from Borough Market. .</p>

E.P.C. RATING: D

Property Features

. Balcony . Combination of wooden floors and carpets . Luxury Appliances . Close to local amenities . Close to Tube . Zone 1 . 5 weeks deposit . Two Bathrooms . Open plan . Private Development . Double Glazed . Excellent decorative order



2 Bedroom Apartment To Rent In Borough / Southwark £ 669 p.w. (£2900 pcm)

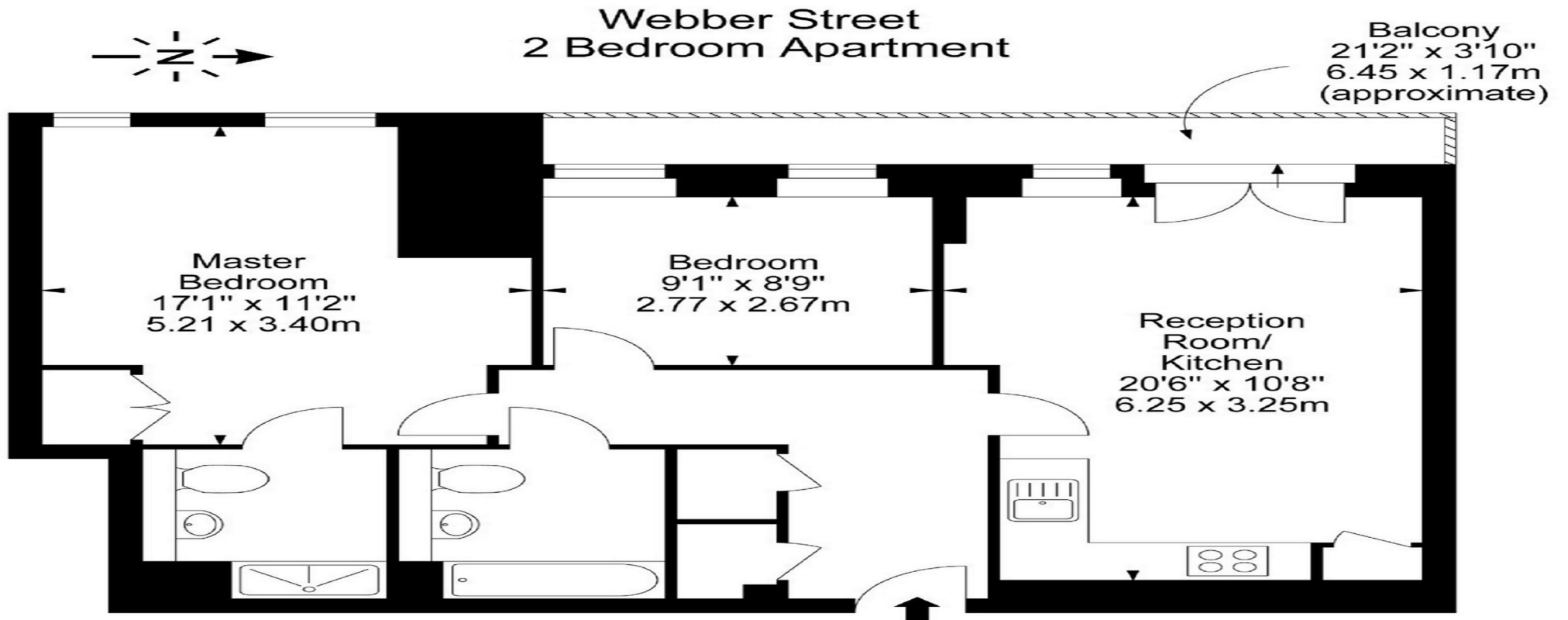

2 Bedroom Apartment To Rent In Borough / Southwark £ 669 p.w. (£2900 pcm)



**78 Borough High Street
London Bridge
SE1 1LL**

**Manager: Alex Nunzi
Email: alex@blackkatz.com
Tel: 020 7403 5010**

**Office Hours:
Mon-Fri 9.00am-7.00pm
Sat-10am-2.00pm
(Please call beforehand)**

**Admin: Amy Burbridge
Email: amy.burbridge@blackkatz.com**

We aim to make our particulars both accurate and reliable. However they are not guaranteed, nor do they form part of an offer or contract. If you require clarification on any points then please contact us. Please note that appliances and heating systems have not been tested and therefore no warranties can be given as to their good working order.