

# BLACK KATZ

Management & Lettings



**2 Bedroom Flat To Rent In Regents Park £625pw (£2708 pcm)**

## **2 Bedroom Flat To Rent In Regents Park£ 625pw (£2708 pcm)**

**<p>A beautiful newly refurbished two bedroom flat located within a stones throw to Regents Park and a short walk to Camden Tube and High Street. This attractive apartment has a large open plan kitchen lounge, modern tiled bathroom with shower, two bedrooms and good storage space. Parkway is located in the heart of the dynamic and culturally diverse area of Camden and within easy reach of the highly desirable area of St. John&#39;s Wood and Regent&#39;s Park. Transport links include Camden Town Underground Station (Northern Line).</p>**

**E.P.C. RATING: C**

### **Property Features**

**. Combination of wooden floors and carpets . Washing Machine . Luxury Appliances . Fitted Kitchen . Close to local amenities . Close to Tube . Fantastic Transport Links . Tiled bathroom . Period Conversion . Excellent decorative order . Spacious Living Room**



## 2 Bedroom Flat To Rent In Regents Park £ 625pw (£2708 pcm)

APPROXIMATE FLOOR AREA = 709 SQ FT / 65.9 SQ M

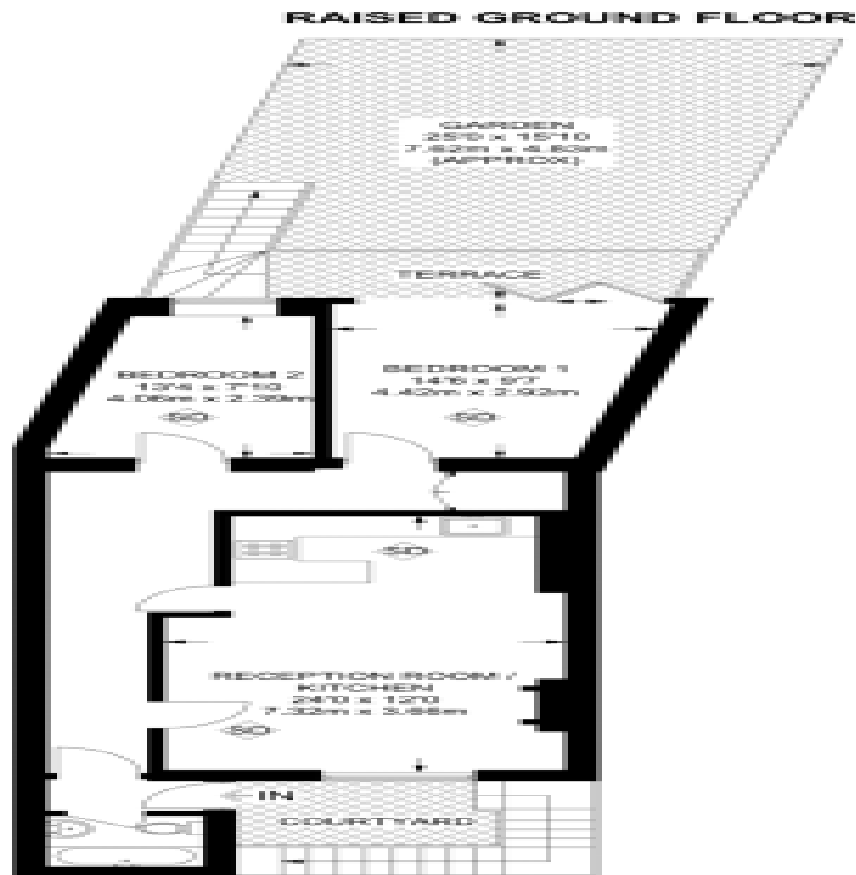

## 2 Bedroom Flat To Rent In Regents Park£ 625pw (£2708 pcm)



**69 Parkway  
Camden Town  
London  
NW1 7PP**

**Manager: Dani Anwar  
Email: [dani@blackkatz.com](mailto:dani@blackkatz.com)  
Tel: 020 7284 3111**

**Admin: Lauren Dean  
Email: [lauren@blackkatz.com](mailto:lauren@blackkatz.com)**

**Office Hours:  
Mon-Fri 9.00am-7.00pm  
Sat-10am-2.00pm  
(Please call beforehand)**

We aim to make our particulars both accurate and reliable. However they are not guaranteed, nor do they form part of an offer or contract. If you require clarification on any points then please contact us. Please note that appliances and heating systems have not been tested and therefore no warranties can be given as to their good working order.