

# BLACK KATZ

Management & Lettings

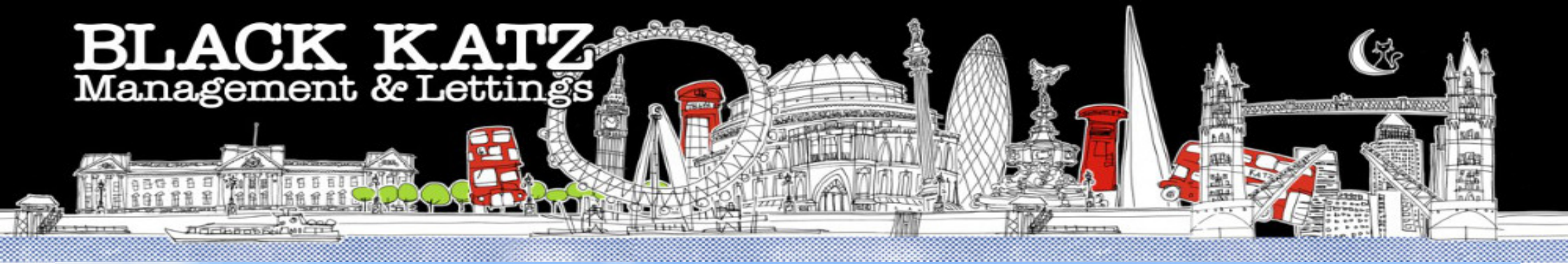

**3 Bedroom Apartment Rent In London Bridge £ 700 p.w. (£3033 pcm)**

### **3 Bedroom Apartment Rent In London Bridge£ 700 p.w. (£3033 pcm)**

--Available 20th September--</p><p>Black Katz London Bridge are pleased to present this superbly located apartment. arranged over two floors of this beautiful period building. This charming three double bedroomed apartment is neutrally decorated throughout and situated on the second and third floors. Boasting a separate fully fitted kitchen, well portioned rooms, two bathrooms (One en-suite) and good storage.</p><p>For transport this property is superbly located to either Borough tube (Northern line) or London Bridge Station (Northern and Jubilee line and underground). Located just off the ever popular Borough High Street and moments from Flat Iron square,The South Bank, The River Thames and Borough Market.</p>

**E.P.C. RATING: C**

#### **Property Features**

. Carpets throughout . Separate kitchen . Close to local amenities . Close to Tube . Fantastic Transport Links . Zone 1 . 5 weeks deposit . Two Bathrooms . En suite bathroom . Arranged over two floors . Period Conversion . Spacious Living Room

#### **Place of Interest Locally**

London Bridge London Underground Station - 0.35 miles. London Bridge - 0.36 miles. The City Of London School - 0.58 miles. Waterloo Station - 0.77 miles. Southwark Borough Council Municipal Offices (Walworth Road) - 0.9 miles. London School of Business and Finance - 0.98 miles. Liverpool Street Station - 1.17 miles. St Clement Danes C Of E Primary School - 1.26 miles. Hult International Business School - Undergraduate Campus - 1.39 miles. Covent Garden Station - 1.43 miles. Lambeth School of Art - 1.56 miles. Bondway Bus Station Toilets - 1.76 miles. Cleveland Street Car Park - 2.18 miles. Victoria Station - 2.21 miles. St Pancras International - 2.35 miles.





### 3 Bedroom Apartment Rent In London Bridge £ 700 p.w. (£3033 pcm)

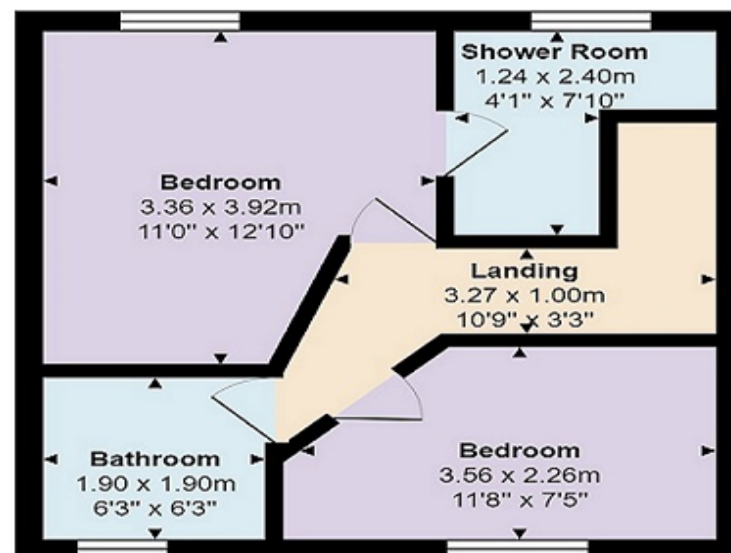
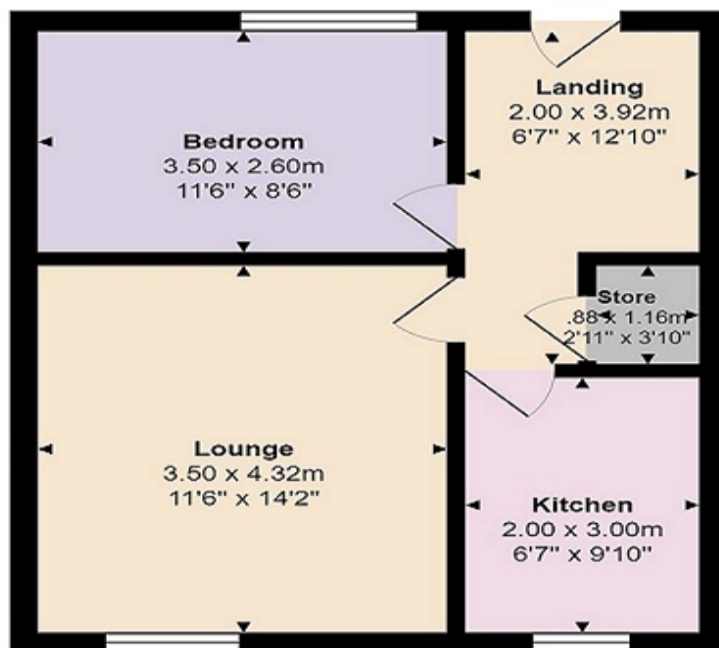



### 3 Bedroom Apartment Rent In London Bridge£ 700 p.w. (£3033 pcm)



**Black Katz**  
**78 Borough High Street**  
**London Bridge**  
**SE1 1LL**

**Manager: Alex Nunzi**  
**Email: alex@blackkatz.com**  
**Tel: 020 7403 5010**

**Admin: Patricia Couto**  
**Email: patricia@blackkatz.com**

**Office Hours:**  
**Mon-Fri 9.00am-7.00pm**  
**Sat-10am-2.00pm**  
**(Please call beforehand)**

We aim to make our particulars both accurate and reliable. However they are not guaranteed, nor do they form part of an offer or contract. If you require clarification on any points then please contact us. Please note that appliances and heating systems have not been tested and therefore no warranties can be given as to their good working order.