

BLACK KATZ

Management & Lettings

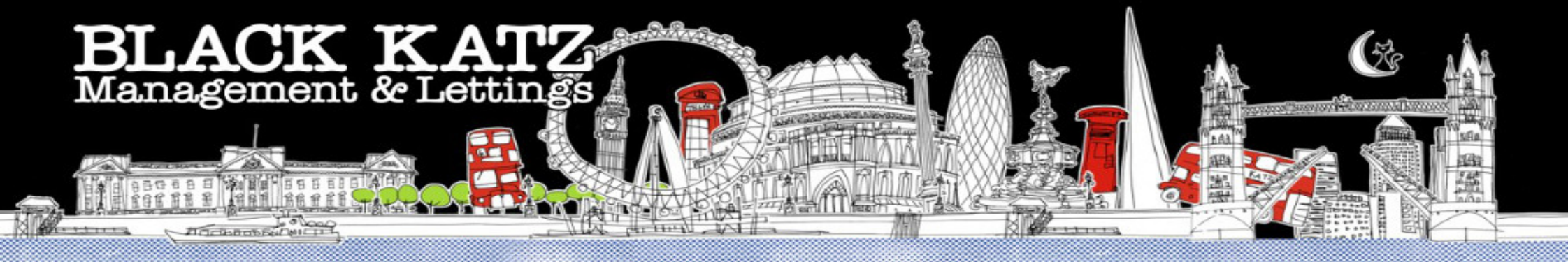

3 Bedroom Flat To Rent In Marylebone £795pw (£3445 pcm)

3 Bedroom Flat To Rent In Marylebone£ 795pw (£3445 pcm)

A large three double bedroom flat in a popular purpose built block, located between Marylebone and St Johns Wood. The property has a large lounge with open plan kitchen, neutral decor, modern bathroom and a mix of carpets and wood floors. Pollitt Drive is located adjacent to St John's Wood Road and is within easy reach of an excellent selection of shops, bars and restaurants in St John's Wood, while the green open spaces of Regent's Park are close by.

E.P.C. RATING: D

Property Features

. Combination of wooden floors and carpets . Washing Machine . Fitted Kitchen . Close to local amenities . Close to Tube . Fantastic Transport Links . Zone 2 . Tiled bathroom . Central Heating . Good decorative order



3 Bedroom Flat To Rent In Marylebone£ 795pw (£3445 pcm)

Pollitt Drive, London, NW8
Approximate Area = 784 sq ft / 72.8 sq m
For identification only - Not to scale

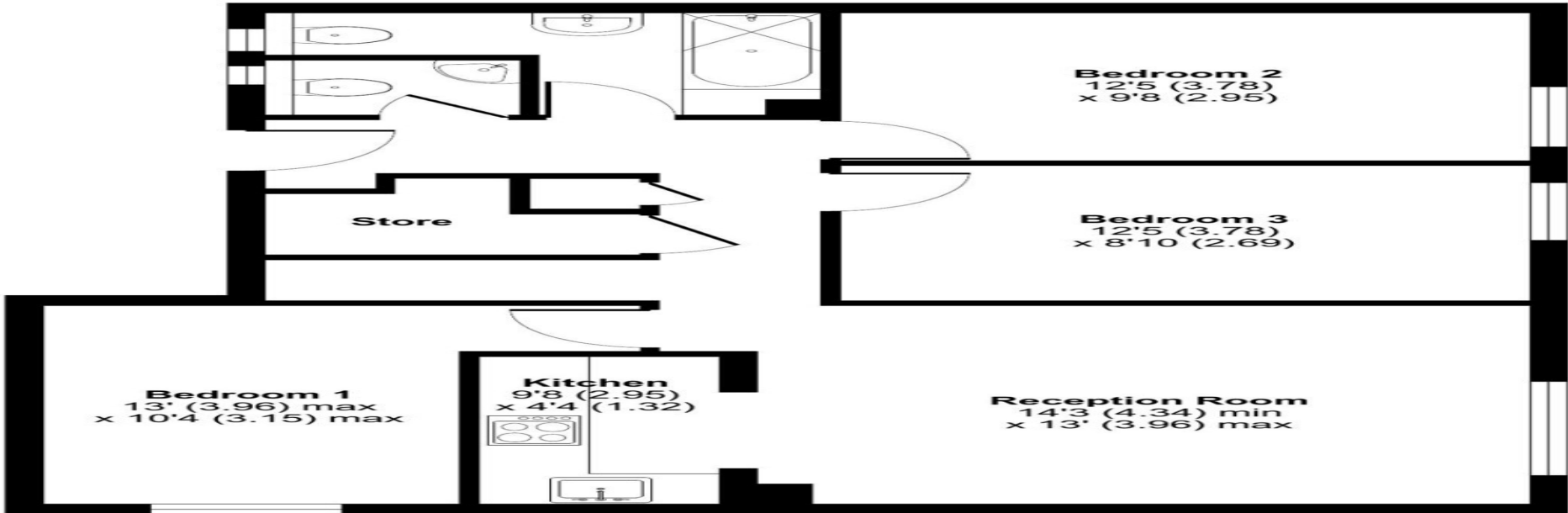

SECOND FLOOR



Floor plan produced in accordance with RICS Property Measurement Standards incorporating International Property Measurement Standards (IPMS2 Residential). © nêhecom 2023. Produced for Dutch & Dutch. REF: 968256

3 Bedroom Flat To Rent In Marylebone £ 795pw (£3445 pcm)



**69 Parkway
Camden Town
London
NW1 7PP**

**Manager: Dani Anwar
Email: dani@blackkatz.com
Tel: 020 7284 3111**

**Admin: Lauren Dean
Email: lauren@blackkatz.com**

**Office Hours:
Mon-Fri 9.00am-7.00pm
Sat-10am-2.00pm
(Please call beforehand)**

We aim to make our particulars both accurate and reliable. However they are not guaranteed, nor do they form part of an offer or contract. If you require clarification on any points then please contact us. Please note that appliances and heating systems have not been tested and therefore no warranties can be given as to their good working order.