

# BLACK KATZ

Management & Lettings



**4 Bedroom Flat To Rent In St Johns Wood £995pw (£4311 pcm)**

## **4 Bedroom Flat To Rent In St Johns Wood£ 995pw (£4311 pcm)**

Black Katz are pleased to offer you this spacious four double bedroom apartment located on prestigious Hamilton Terrace in St Johns Wood. Set on the 2nd floor of a period conversion the property has a large lounge, high ceilings, modern fully fitted kitchen, tiled modern bathroom and good storage space.

Hamilton Terrace is located within close proximity to the large variety of shops, boutiques and restaurants of Little Venice Clifton Gardens and St John's Wood. Transport links including Maida Vale Underground Station, (Bakerloo Line) and St John's Wood Underground Station (Jubilee Line) providing easy access to the West End, City and Canary Wharf.

**E.P.C. RATING: C**

### **Property Features**

**. Washing Machine . Fitted Kitchen . Close to local amenities . Close to Tube . Zone 2 . Period Conversion . Central Heating . Spacious Living Room**





## 4 Bedroom Flat To Rent In St Johns Wood £ 995pw (£4311 pcm)

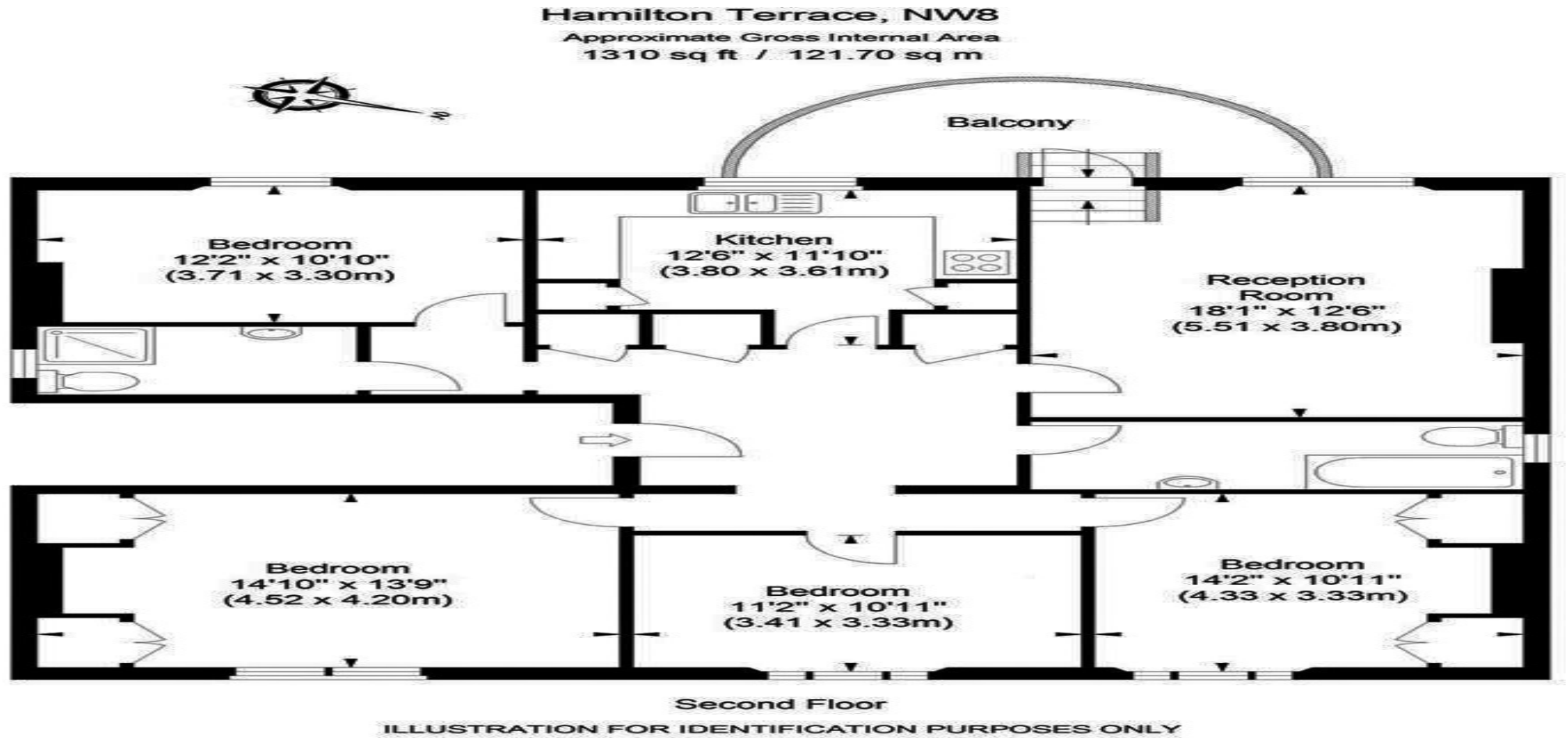

## 4 Bedroom Flat To Rent In St Johns Wood£ 995pw (£4311 pcm)



**69 Parkway  
Camden Town  
London  
NW1 7PP**

**Manager:Dani Anwar  
Email:dani@blackkatz.com  
Tel:020 7284 3111**

**Admin:Lauren Dean  
Email:lauren@blackkatz.com**

**Office Hours:  
Mon-Fri 9.00am-7.00pm  
Sat-10am-2.00pm  
(Please call beforehand)**

We aim to make our particulars both accurate and reliable. However they are not guaranteed, nor do they form part of an offer or contract. If you require clarification on any points then please contact us. Please note that appliances and heating systems have not been tested and therefore no warranties can be given as to their good working order.