

# BLACK KATZ

Management & Lettings



**Studio Apartment Studio To Rent In Wood Green £242pw (£1050 pcm)**

## **Studio Apartment Studio To Rent In Wood Green£ 242pw (£1050 pcm)**

<p>A single self-contained studio located only a short walk to Wood Green Station. The studio is suitable for a single occupant only and has&nbsp;a fully equipped kitchen, tiled shower room and&nbsp;wood floors.&nbsp;The rent is inclusive of water rates and internet&nbsp;</p><p>property is located close to all major high street retail stores within walking distance from property. There are also an array of middle eastern restaurants, bars and fresh fruit and veg stores.</p>

**E.P.C. RATING: E**

### **Property Features**

**. Wood Floors . Washing Machine . Fitted Kitchen . Close to local amenities . Close to Tube . Fantastic Transport Links . Zone 3 . 5 weeks deposit . Tiled bathroom . En suite bathroom . Open plan . Period Conversion . Good decorative order**





## Studio Apartment Studio To Rent In Wood Green £ 242pw (£1050 pcm)

FLAT 1, WOODSIDE ROAD, N22  
TOTAL APPROX FLOOR PLAN AREA 148 SQ.FT (14 SQ.M)  
GROUND FLOOR

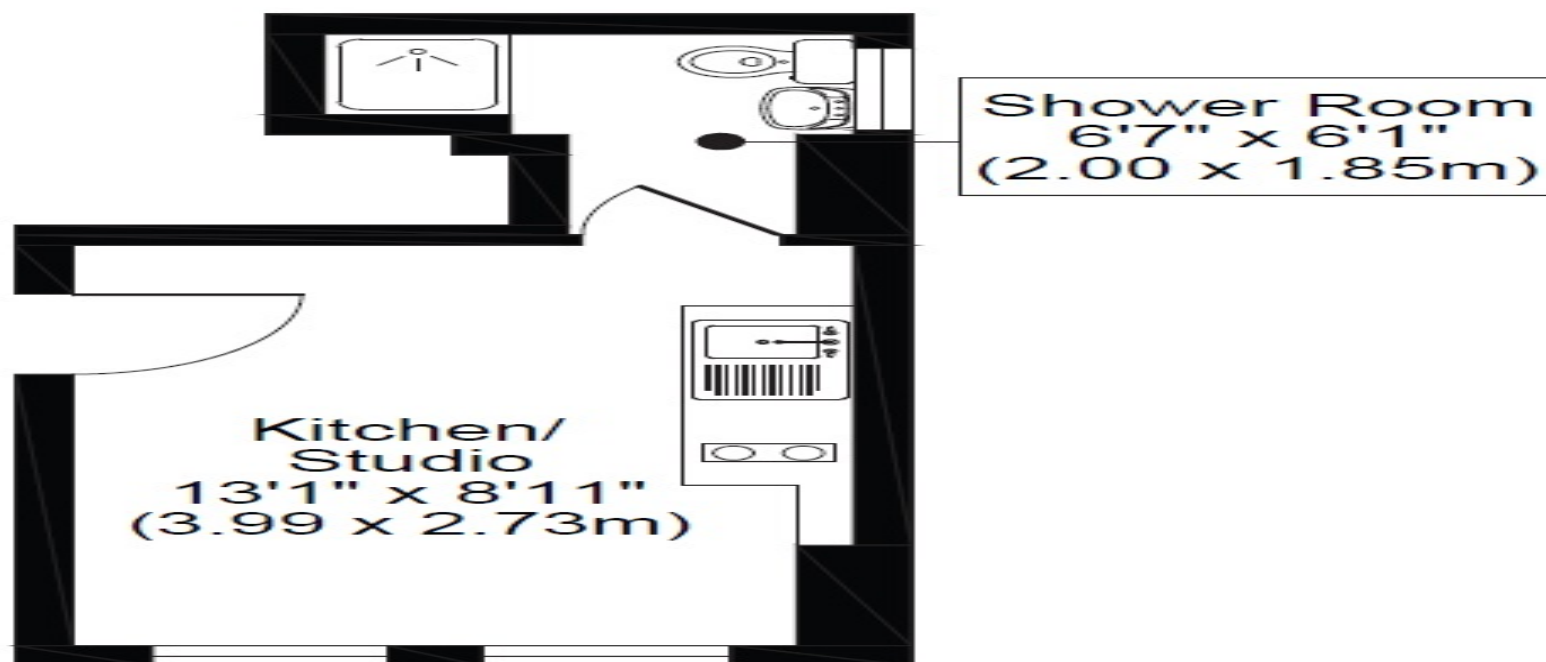

## Studio Apartment Studio To Rent In Wood Green£ 242pw (£1050 pcm)

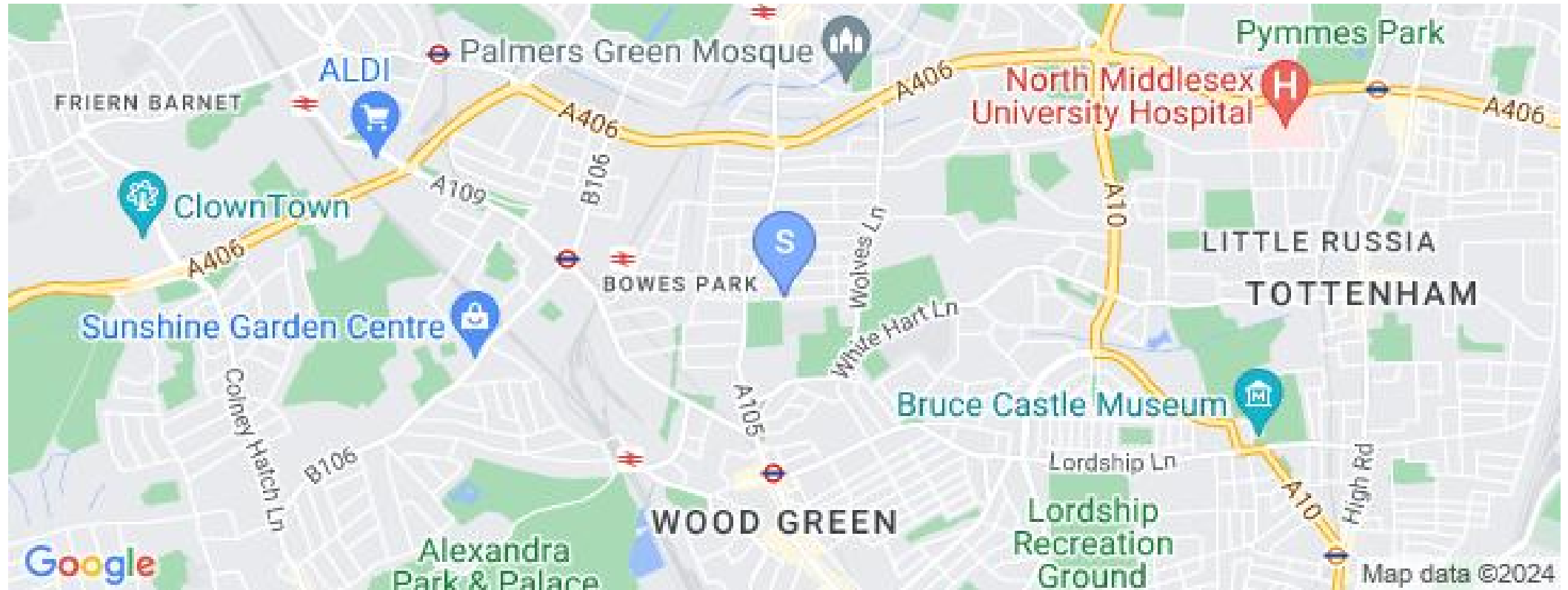

**22 Baron Street  
London  
N1 9ES**

**Manager:Raj Manandhar  
Email:raj@blackkatz.com  
Tel:020 7 713 7337**

**Admin:Alisha Kaur Sangha  
Email:Alisha@blackkatz.com**

**Office Hours:  
Mon-Fri 9.00am-7.00pm  
Sat-10am-2.00pm  
(Please call beforehand)**

We aim to make our particulars both accurate and reliable. However they are not guaranteed, nor do they form part of an offer or contract. If you require clarification on any points then please contact us. Please note that appliances and heating systems have not been tested and therefore no warranties can be given as to their good working order.